

State Well Report

Part 1

Mississippi Department of Environmental Quality
 Office of Land and Water Resources
 P.O. Box 10631
 Jackson, MS 39289-0631
 (601)961-5210
 (601)354-6938 (fax)

For Office Use Only:

Aquifer: _____
 Well #: G-89 033
 L. S. Elevation: _____
 E-log #: _____

County: Desoto
 Permit #: No Permit
 Driller: Pete Sappington
 Date drilling completed: 9/16/04

State Law requires that this report be prepared by the driller in detail and filed with the Department within 30 days of completion of drilling of the well.

Well Owner Information	Well Location
Owner Name: <u>REEDS William</u>	Latitude: _____ Longitude: _____
Mailing Address: <u>8727 Northwest DR</u>	Method of Lat/Long (circle one): Conventional Survey, USGS quad, Hand-held GPS, Survey-grade GPS
<u>Southeastern</u> <u>MS</u> <u>38671</u>	_____ 1/4 _____ 1/4 Sec <u>11</u> Twn <u>25</u> Rng <u>7W</u>
City State Zip Code	Distance Direction Nearest Town
Telephone No. <u>(662) 393 4250</u>	<u>2</u> Miles <u>East</u> of <u>Getwell Rd</u> <u>on College Rd Southaven</u>
Well Data	
Purpose of Well (circle one) Home Industrial Public Supply <u>Irrigation</u> Fish Culture Other: _____	
Date well drilling started: <u>9/16/04</u> Date well drilling completed: <u>9/16/04</u>	
If flowing, method of flow regulation: Valve _____ Other (describe) _____	
Static Water Level: <u>137</u> feet above or <u>below</u> (circle one) land surface Date measured: <u>9/17/04</u>	
Method of Measurement (circle one) <u>steel tape</u> electric tape air line other: _____	
Hole depth: <u>250'</u> Well depth: <u>246</u> Well grouted to a depth of <u>10</u>	
Type of grout (circle one): Cement <u>Bentonite</u> Mix	
Casing length: <u>216</u> feet Casing diameter: <u>4</u> inches Type of casing: <u>PVC</u>	
Screen length: <u>30</u> feet Screen diameter: <u>4</u> inches Type of screen: <u>PVC</u>	
Screen slot size: <u>013</u> inches Setting depth: From <u>216</u> feet to <u>246</u> feet	
Type of completion (circle all applicable): <u>Gravel packed</u> Underreamed Telescoped Open hole Natural Development	
Other (describe): _____	
Top of lap pipe or reduction in casing: _____ feet. If telescoped or more than one screen, describe on back of page	
Logs run (circle all applicable): No log run Electric Gamma Ray Density Sonic Neutron Other: _____	
Name of organization running log(s): _____	
I certify that the well was drilled, constructed, and completed in accordance with all applicable requirements of the Mississippi Department of Environmental Quality and/or the Mississippi Department of Health regulations and state laws.	
<u>Pete Sappington</u>	<u>Pete Sappington</u>
Print Name of Water Well Contractor and License No. <u>0430</u>	Signature of Water Well Contractor

RECEIVED
 OCT 08 2004
 BY: OLWR

If well telescopes please sketch below and show depths.

Ground Level

G-89

Description of Formations Encountered

From To

Description of Formations Encountered	From	To
0-44 Red clay	0	44
LARGE GRUKL	44	65
Blue clay	65	200
White sand	200	260

If more than one screen, show location of each on sketch

Sketch the property layout and include the following: 1) the well location; 2) any permanent structures on the property that may aid in locating the well; 3) any roads, power lines, or other items that may aid in locating the property and the well; 4) indicate direction.

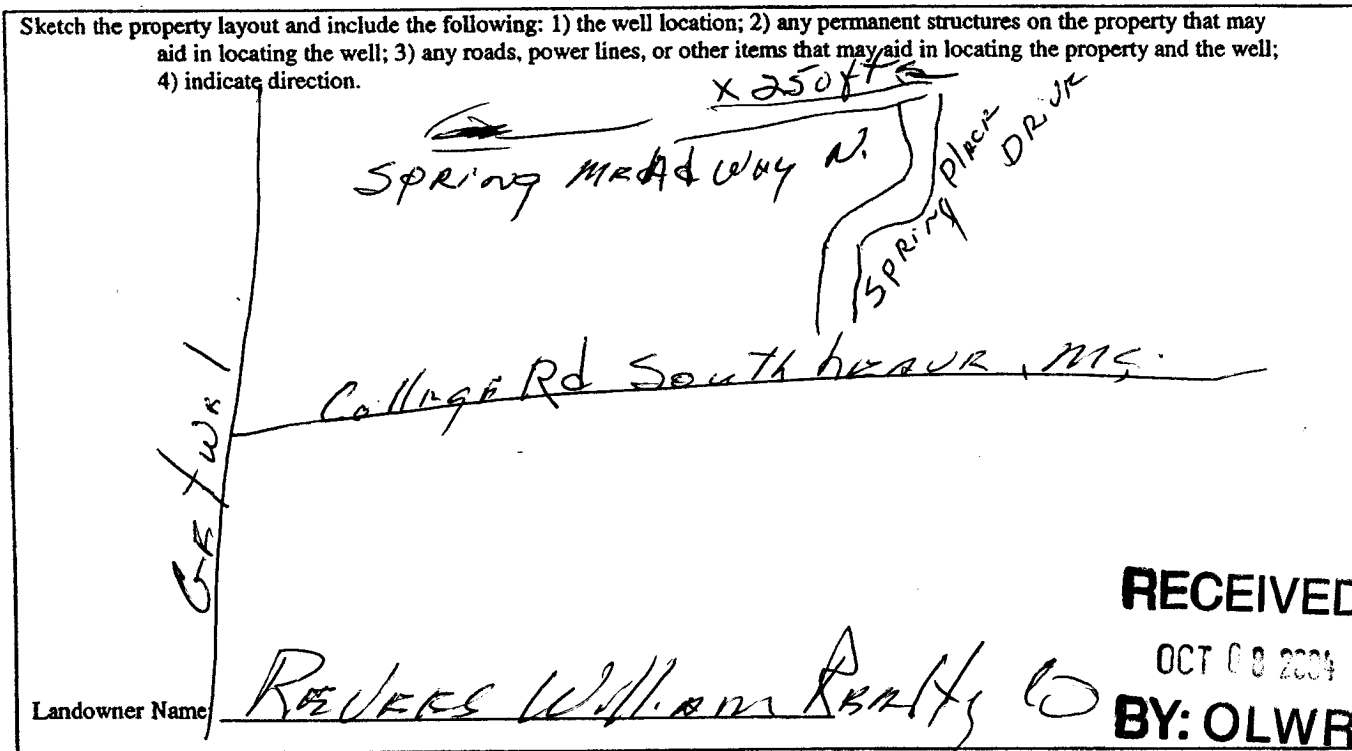

RECEIVED
OCT 08 2004
BY: OLWR

Phil Sapp
Signature of Water Well Contractor

RECEIVED
OCT 08 2004
BY: OLWR

STATE WELL REPORT

Part 2

Pump Installer's Completion Report
 Mississippi Department of Environmental Quality
 Office of Land and Water Resources
 P.O. Box 10631
 Jackson, MS 39289-0631
 (601)961-5210
 (601)354-6938 (fax)

For Office Use Only:

Aquifer: _____

Well #: G-89

Elevation: _____

County: MISSISSIPPI
 Permit #: NO PERMIT
 Driller: Pete Sappington
 Date completed: 9/17/04

This report should be prepared by the pump installer in detail and filed with the Department within 30 days of the installation of pump.

Well Owner Information	Well Location
Owner Name: <u>Reeves Williams</u>	Latitude: _____ Longitude: _____
Mailing Address: <u>8727 Northwest Dr</u>	Method of Lat/Long (circle one): Conventional Survey,
<u>SOUTHAVEN, MS 38671</u>	USGS quad, Hand-held GPS, Survey-grade GPS
City State Zip Code	<u>1/4 1/4 Sec 11 Twn 25 Rng 7W</u>
Telephone No. <u>(662) 393 4250</u>	Distance Direction Nearest Town
	<u>2 Miles EAST of GATWILL RD</u>
	<u>ON COLLIER RD SOUTHAVEN MS</u>

Pump Type Circle one	Power Type Circle one
Air Lift Jet <input type="radio"/> <u>Submersible</u> <input type="radio"/>	Diesel Engine Gasoline Engine Natural Gas
Bucket Piston <input type="radio"/> Turbine <input type="radio"/>	<u>Electric Motor</u> <input type="radio"/> Hand <input type="radio"/> Tractor PTO
Centrifugal Rotary <input type="radio"/> Flowing Well <input type="radio"/>	Windmill Other (specify): _____
Other (specify): _____	Horse Power Rating of Motor: <u>5HP</u>
Date Pump Installed: <u>9/17/04</u>	Setting Depth: 180 <u>189</u> feet
Rated Pump Capacity: <u>45 @ 60 PSI</u> Gallons Per Minute	Number of Stages: <u>6</u>

RECEIVED
 OCT 08 2004
 BY: OLWR

Pump Test Data	Method of Measuring Water Level Circle one
Date Well Tested: <u>9/17/04</u>	Air Line Electric Measuring Line <u>Steel Tape</u> <input type="radio"/>
Static Water Level (A): <u>137</u> Feet Below Land Surface	Other (specify): _____
Pumping Water Level (B): <u>NOT TESTED</u> Feet Below Land Surface	For flowing well, measured shut in head: _____ feet
Drawdown [(B) - (A)]: <u>UNKNOWN</u> Feet Below Land Surface	Well yielded <u>65</u> GPM with a drawdown of
Test Pumping Rate: <u>65</u> Gallons Per Minute	<u>UNKNOWN</u> feet after <u>4</u> hours of pumping
Duration of Pump Test (minimum 4 hours): <u>4</u> hours	

I HEREBY CERTIFY that the above statements are true to the best of my knowledge.

Pete Sappington Pete Sappington
 Print Name of Pump Installer and License No. (if applicable) 0432 Signature of Pump Installer